

FOR IMMEDIATE RELEASE:

**MEDIUM-TERM NIGHT LANE CLOSURE ON JALAN DAMANSARA**

<b>Location</b>	Jalan Damansara
<b>Date</b>	1 – 29 June 2015
<b>Time</b>	11:00 pm – 5:00 am
<b>Duration</b>	29 nights
<b>Reasons</b>	Removal of construction waste materials from the station box

**KUALA LUMPUR, 27 MAY 2015:** MMC Gamuda KVMRT (T) Sdn Bhd (MGKT) wishes to announce a medium-term night lane closure on Jalan Damansara (Kuala Lumpur-bound), located in front of Muzium Negara between **1 June 2015 and 29 June 2015**, to facilitate removal of construction waste materials from the station box for the MRT project.

The closure, involving a 50-metre stretch of the two left lanes along Jalan Damansara (KL-bound) will be implemented from **11:00 pm till 5:00am**. The fast lane will remain open for traffic during the closure. Please see Map below on the location of the closure.

**MEDIUM-TERM NIGHT LANE CLOSURE ON JALAN DAMANSARA**

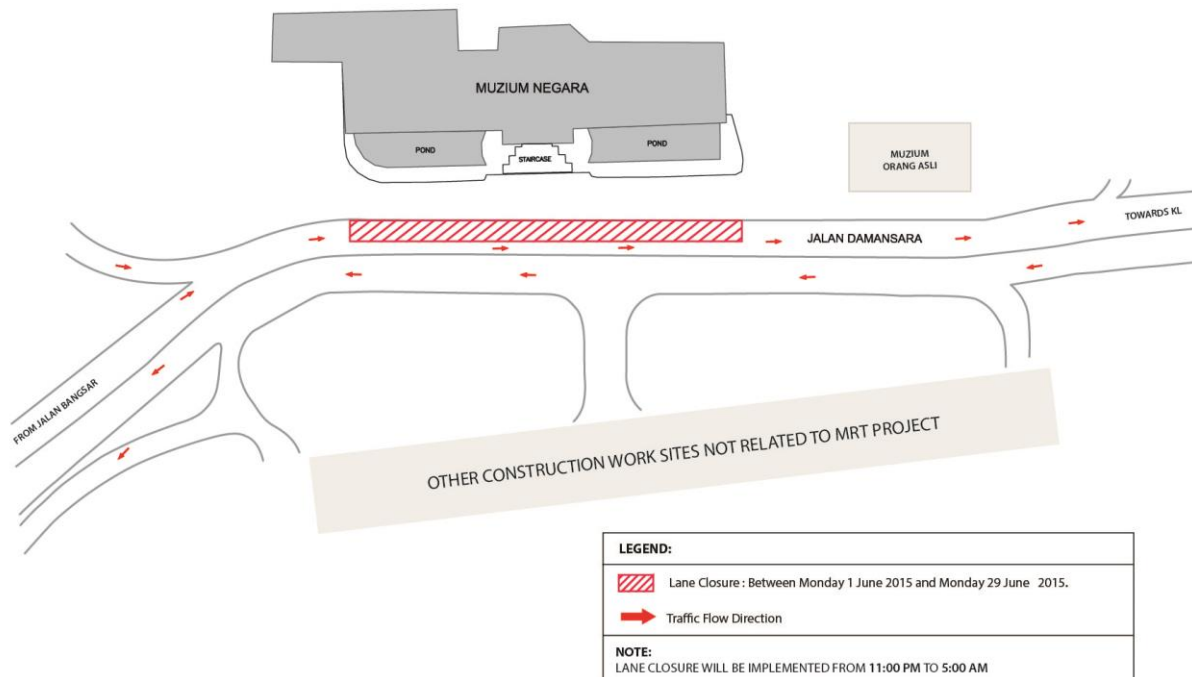

Motorists are advised to follow the directional signage during the closure and the MRT Project Emergency Response Team will be deployed to help direct traffic. MGKT wishes to apologise for the inconvenience caused.

For more information the public can visit the MRT website at [www.mymrt.com.my](http://www.mymrt.com.my) or [www.mymrt-underground.com.my](http://www.mymrt-underground.com.my), Twitter @MRTMalaysia or @MRTUnderground, Facebook @MRTMalaysia or @MRTUnderground or call the MRT Hotline at 1-800-82-6868.

**-END-**

**For media enquiries, please contact:**

**MMC Gamuda KVMRT (T) Sdn Bhd**

Ms Jalina Joheng

016-9105353 / [jalina@kvmrt-ug.com.my](mailto:jalina@kvmrt-ug.com.my)